

Interior View of Back Cover

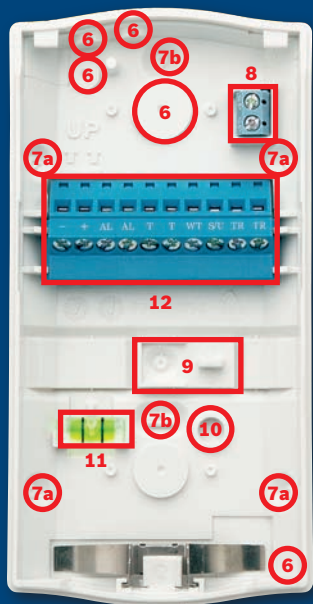

- 6.** Wire knock-outs (5)
- 7a.** Corner mount knock-outs
- 7b.** Surface mount knock-outs
- 8.** SP: Spare terminals**
- 9.** Wall tamper break-away
- 10.** Vertical level holder
- 11.** Horizontal level
- 12.** Removable terminal strip
 - Trouble terminals are only available on the Dual Detector

** On PIR Detector spare terminals are located on the main terminal block

LED Indicators Used to Check Detector Sensitivity

LED	Display	Dual Detector	PIR Detector
	None	No activity	No activity
BLUE	Flashing up to 2 minutes	Warm-up period	Warm-up period
	Displays for 5 seconds	PIR + microwave alarms	PIR alarm
	3 flashes	Anti-mask condition detected	—
	4 flashes	Self-test and remote test failure	—
	5 flashes	Low-voltage input supervision	—
YELLOW		Microwave alarm condition	—
RED		PIR alarm condition	—

Bosch Security Systems, Inc.
 130 Perinton Parkway
 Fairport, NY 14450 U.S.A.
 Tech Support: 888.886.6189

All rights reserved
 Printed in U.S.A.
 Part # F01U029827A

Professional Series Intrusion Detectors

Know when to alarm. Know when not to.



ISC-PPR1-W16 ISC-PDL1-W18G

Interior View of Front Cover

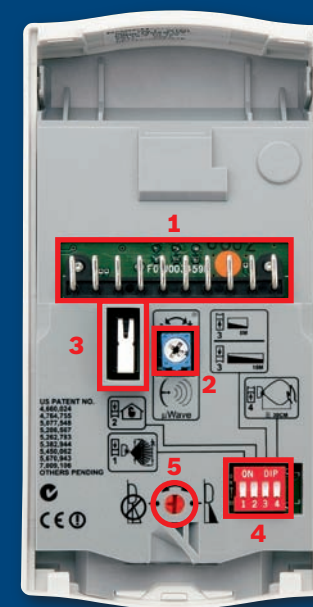

- 1.** Header pins
- 2.** Microwave range adjustment*
- 3.** Tamper switch
- 4.** DIP switches
- 5.** PIR look-down sensitivity adjustment

*Available only on the Dual Detector

Identify optimum detector locations

- ▶ Stable, vertical surface
- ▶ Mounting height of 7–10 ft (2.1–3 m)
- ▶ Traffic pattern coverage
 - Cross-catch is best
 - Use multiple detectors to improve security

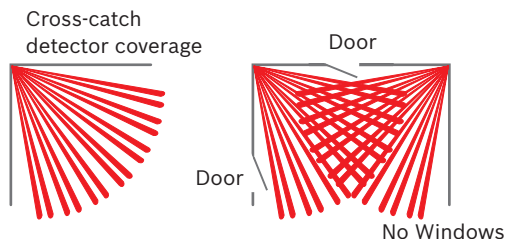

Identify and avoid environmental issues that could affect detector performance

- ▶ Avoid pointing detector at windows, uninsulated walls, moving objects, heat & ventilation sources, large metal objects
- ▶ Avoid installing above fluorescent lights or behind the top edge of doors
- ▶ Avoid extreme interior conditions
 - <-32°F / >120°F (<0°C / >48°C); >95% RH

Detector Installation Procedure

1. Open the wiring knock-outs and (optional) wall tamper break-away. *See the Interior View of Back Cover Illustration.*

2. Confirm that the detector is level.

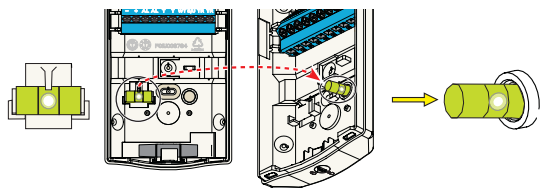

3. Mount the detector either flat against the mounting surface, in the corner, on the ceiling (using brackets B338), or using wall-mount brackets (using B328 or B335).

4. Run the wires from the panel to the detector.

- 16 – 25 AWG

5. Set Remote Walk Test and Alarm Memory options. *See the additional information on these two features included in this document.*

6. Set the PIR sensor range (optional).

Range	DIP
Short 25 ft x 33 ft (8 m x 10 m)	DIP 3 - ON
Long (PIR) 50 ft x 70 ft default (15 m x 21 m default)	DIP 3 - OFF
Long (Dual) 60 ft x 80 ft default (18 m x 24 m default)	DIP 3 - OFF

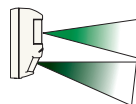

7. (Optional) Set the PIR sensor look-down range to provide coverage. This feature is turned off as the default setting. Coverage can be adjusted to include a range of up to 6 ft (1.8 m) from the mounting surface.

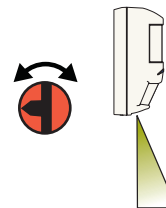

8. (Optional) Mask the detector to reduce the coverage area.

- Mark the masking decal
- Cut the decal to size
- Apply to the outside surface of detector lens(es)

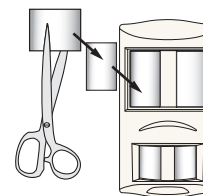

9. Perform walk test to verify detector coverage. (See LED Indicator chart for visual indications of detector sensitivity.)

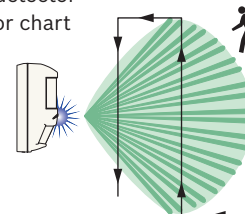

10. (Dual Detector only, Optional) Adjust microwave range for smaller room applications. Perform a walk test if any adjustments were made. NOTE: The microwave range setting is factory adjusted to provide 60 ft (18 m) of coverage.



Local LED Control

If the remote walk test feature is not used, the LED can be turned on or off using DIP 1. DIP 1 ON = LED off; DIP 1 OFF = LED on.

Remote Walk Test

The Remote Walk Test input has an internal pull-up for use with control panels that have an open collector output. DIP 1 is used to set the control panel signal level.

DIP 1	Control Panel Output with WT Enabled
OFF	High – 12V
ON	Low – 0V

Alarm Memory (S/U)

The alarm memory input (S/U) has an internal pull-up; this allows it to be used with a control panel that has an open collector output.

DIP 2	Control Panel Output	
	Disarmed	Armed
OFF	12V	0V
ON	0V	12V

Enabling Wall Tamper Feature (surface mounting)

1. Punch out the wall tamper break-away with a flat screwdriver before mounting the unit. *See the Back Cover Illustration.*
2. Attach the detector to the mounting surface.
3. Insert the wall tamper break-away inside the detector and screw it into the wall.
4. Slide the detector closed.