

**ISW-BMC1-R135X (868 MHz)**  
**ISW-BMC1-R135Y (915 MHz)**

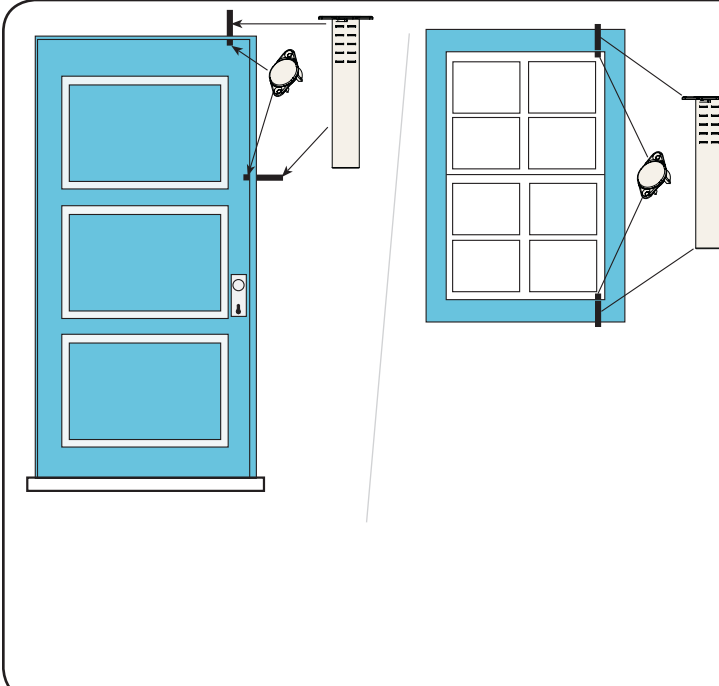

**wLSN**  
**Recessed Door-Window Contact**  
**Installation Instructions**

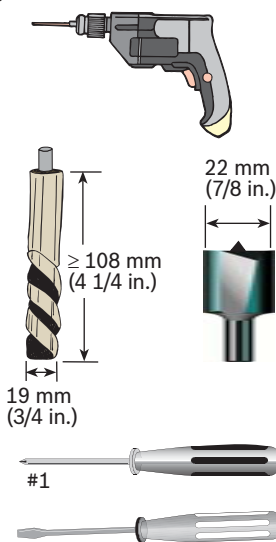
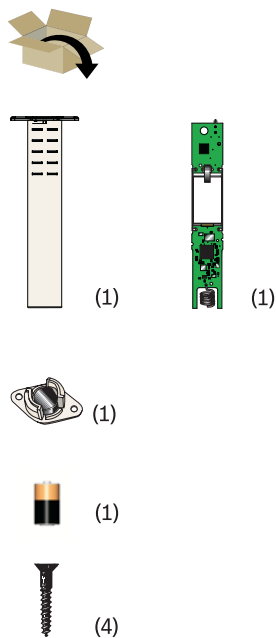

NF A2P Distances (mm)		
Wood/Bois	O	F
X	26	23
Y1	26	20
Y2	24	20
Z	22	17
Metal	O	F
X	25	19
Y1	24	20
Y2	22	18
Z	22	17

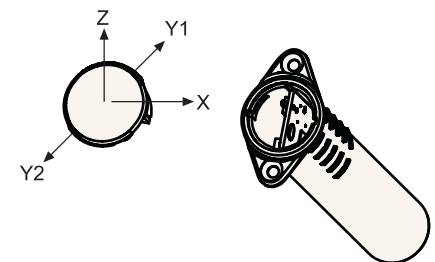

**ISW-BMC1-R135X (868 MHz):**



EN50131-1, EN50131-6, EN50131-5-3 Grade 2

Environmental Class II

IP30/IK04 (EN60529, EN62262)



Certification NF A2P Type 2  
 Attestation 2120000330 délivrée par  
 AFNOR Certification 93571 La Plaine St Denis  
 CNPP Certification 27950 St Marcel  
 Pour son usine : 000110P2

**ISW-BMC1-R135Y (915 MHz):**

FCC, Part 15

IC: Industry Canada RSS-210

UL634: Standard for Connectors and Switches for Use with Burglar Alarm Systems

ULC C634-M1986: Standard for Connectors and Switches for Use with Burglar Alarm Systems

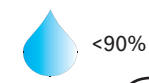
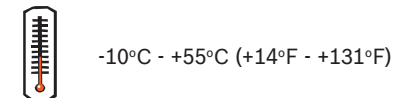
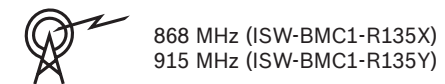
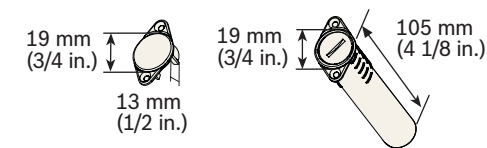

[www.boschsecurity.com](http://www.boschsecurity.com)  
 © 2009 Bosch Security Systems, Inc.  
 F01U011878-02

1

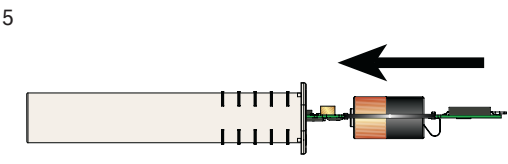
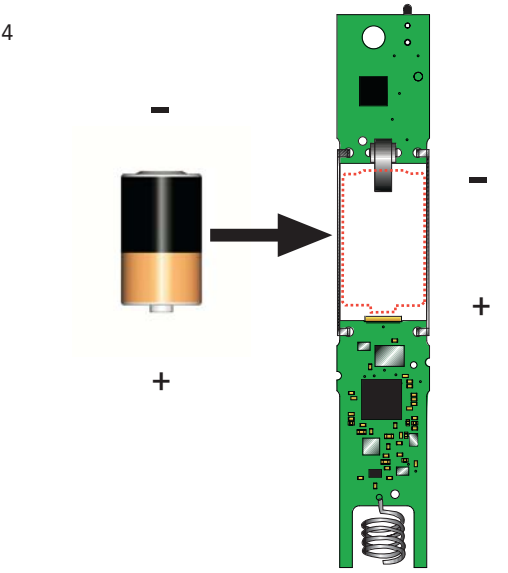
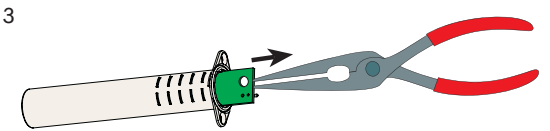
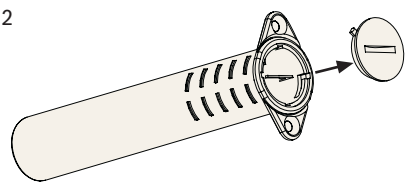
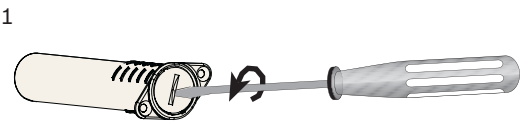

6



2

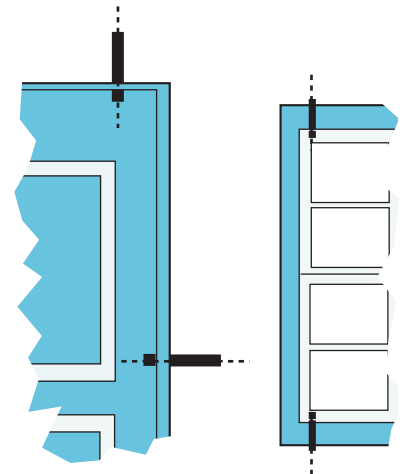

3-1

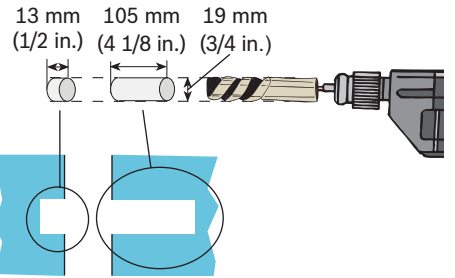
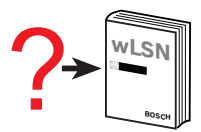

1

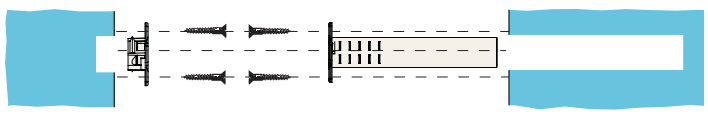

2

3-2

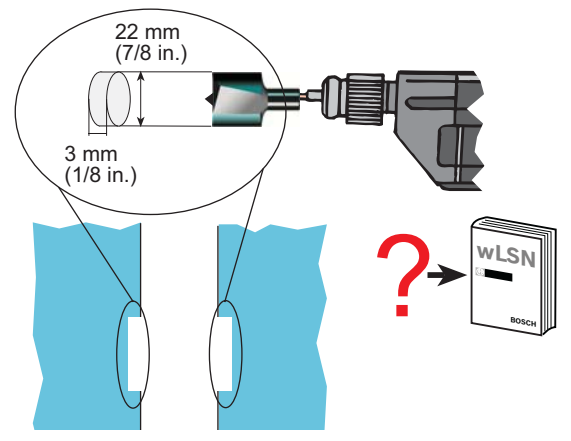

1

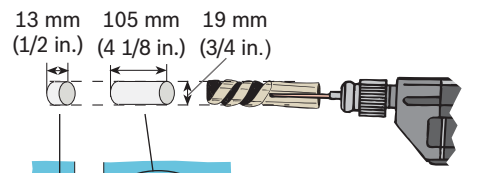

2

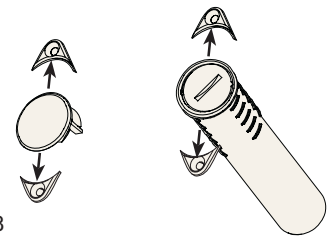

3

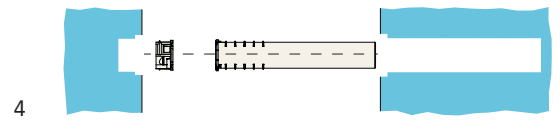

4

© 2009 Bosch Security Systems, Inc. F01U011878-02

